

SERVICE BULLETIN

DATE: August 3, 2000

PAGE 1 of 5

// MANDATORY ////////////////////////////////// MANDATORY ////////////////////////////////// MANDATORY //

TAIL ROTOR GEARBOX ATTACHING BOLTS, ONE TIME INSPECTION

1. PLANNING INFORMATION

A. Aircraft Affected:

369D/E/F/FF helicopters with Yehnert modified tailbooms (p/n YH-228) installed per STC SH5055NM.

369D/E helicopters with tail rotor gearbox attaching hardware modified per STC SH4801NM (p/n YH-220).

Note: 369D/E/F/FF helicopters with Aerometals manufactured tailbooms p/n YH-228, s/n A201 and subs, are not affected by this Service Bulletin.

B. Assembly/Components Affected By This Notice:

NAS6204 bolts or NAS1304 bolts attaching the tail rotor gearbox to the tailboom.

C. Reason:

The tail rotor gearbox attaching bolts identified in the maintenance instructions previously supplied with STC5055NM and STC4801NM identify the tail rotor gearbox attaching bolts as NAS6204-25. But the bolts originally shipped with these tailbooms were NAS1304-26. If the NAS6204-25 bolts identified in the maintenance instructions are installed, it is possible to have inadequate thread protrusion above the self-locking nutplates. Also, variations in material thicknesses require each bolt to be inspected for a minimum of one thread protrusion above the nutplate.

D. Description:

This Bulletin provides operators with the procedure to verify the proper tail rotor gearbox attaching bolts.

E. Time of Compliance

The requirements of this Bulletin shall be accomplished within the next 25 hours of helicopter operation.

F. FAA Approval:

The technical aspects of this Bulletin are FAA approved.

// MANDATORY ////////////////////////////////// MANDATORY ////////////////////////////////// MANDATORY //

SERVICE BULLETIN

DATE: August 3, 2000

PAGE 2 of 5

// MANDATORY ////////////////////////////////// MANDATORY ////////////////////////////////// MANDATORY //

G. Manpower:

1 man-hour

H. Interchangeability:

None

I. Material/Part Availability:

Table 1 - REPLACEMENT PARTS/SUPPLIES			
<u>Description</u>	<u>Part No.</u>	<u>Qty</u>	<u>Source</u>
Bolt	NAS1304-26	A/R	Commercial
Washer	AN960D416	A/R	Commercial

Table 2 - TOOLS & EQUIPMENT		
Either of the following inspection methods may be used. For each method, the following is required:		
<u>Method No.</u>	<u>Description</u>	<u>Source</u>
I	1" wide inspection mirror	Any
II	Approx. 6mm diameter flexible borescope	Any

J. Warranty Policy:

None

K. Weight & Balance:

N/A

L. Other Publications Affected:

Document YH-237, Procedures for Inspection of YH-228 Tail Boom, is revised as a result of this Bulletin. FAX the attached Compliance Recording Form to the Aerometals Engineering Department (FAX: 916-939-6555, Phone: 916-939-6888) for a copy.

// MANDATORY ////////////////////////////////// MANDATORY ////////////////////////////////// MANDATORY //

SERVICE BULLETIN

DATE: August 3, 2000

PAGE 3 of 5

// MANDATORY ////////////////////////////////// MANDATORY ////////////////////////////////// MANDATORY //

2. INSPECTION PROCEDURE

Using either a mirror or a borescope, perform the following inspection:

1. Identify and record the p/n of the bolts currently attaching the tail rotor gearbox to the tailboom on the attached Compliance Recording Form.
2. If the bolts' part numbers are not NAS1304-26, remove and replace them with NAS1304-26 bolts.
3. Torque bolts to 100-110 in-lbs (11.3-12.4 N-m) and apply torque stripe paint.
4. Remove the tailboom control rod from the tailboom in accordance with the MDHI Basic Handbook of Maintenance Instructions, section 67-20-10.
5. Insert the mirror or borescope into the aft section of the tailboom.
6. Inspect the nutplates on the internal surface of the aft tailboom frame casting, p/n 369D23503 as shown in *Figure 1*.
7. Check the number of threads protruding out of the nutplate for each of the four gearbox to tailboom attachment bolts. One to four threads should protrude. If more than four threads protrude, use one additional AN960D416 washer.
8. Complete and submit the Compliance Recording Form from this bulletin to Aerometals. Upon receipt of the form, Aerometals will provide the Procedure for Installation and Inspection of YH-228 Tail Boom, which replaces all previous revisions.
9. Between 2 and 10 hours of helicopter operation (to allow parts to seat), check the torque of each replaced bolt by applying 100 in-lbs (11.3 N-m). Reapply torque stripe paint. If any movement of any bolts occurred, this torque check procedure must be repeated after 2 to 10 hours of helicopter operation.

// MANDATORY ////////////////////////////////// MANDATORY ////////////////////////////////// MANDATORY //

SERVICE BULLETIN

DATE: August 3, 2000

PAGE 4 of 5

// MANDATORY ////////////////////////////////// MANDATORY ////////////////////////////////// MANDATORY //

3. DISPOSITION OF PARTS REMOVED

Discard all NAS6204-25 bolts

4. POINTS OF CONTACT

For further assistance, contact Aerometals Engineering Department, 3920 Sandstone Dr, El Dorado Hills, CA 95762. Phone 916-939-6888, Fax 916-939-6555.

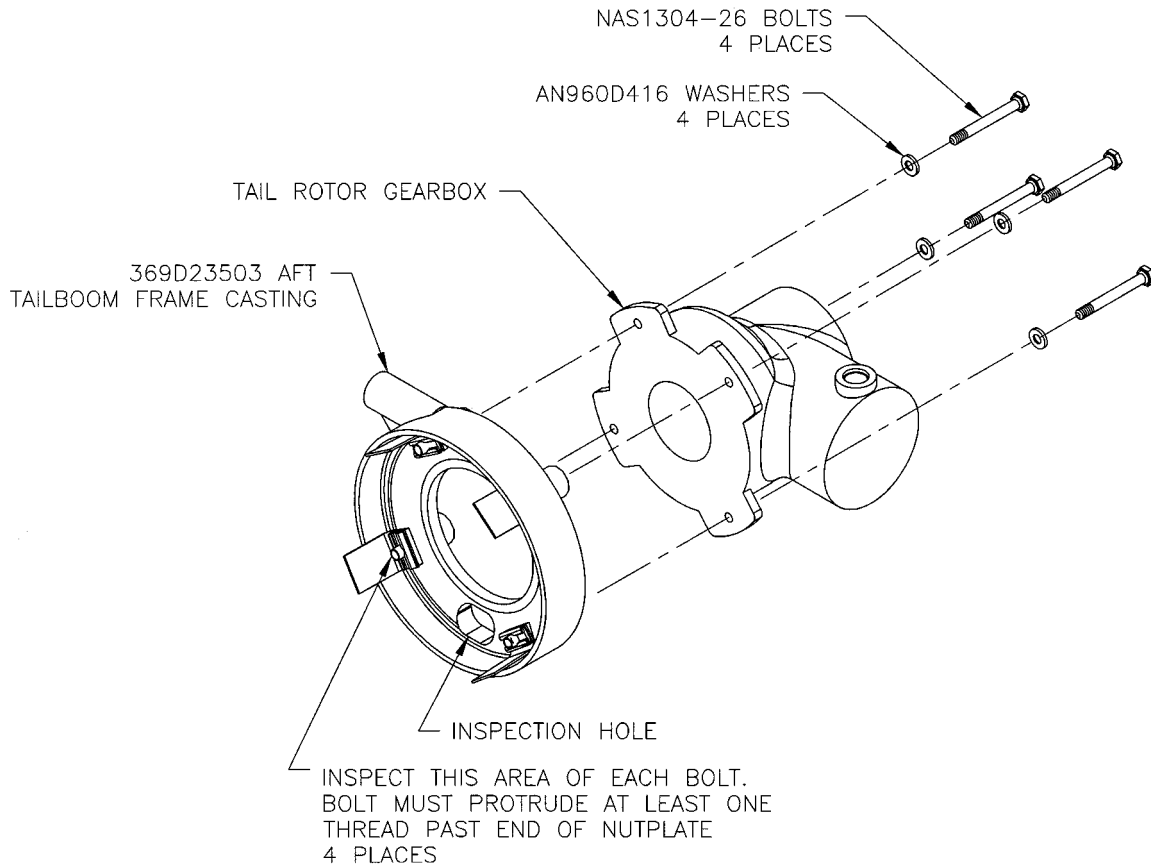

Figure 1 - Inspection Location

// MANDATORY ////////////////////////////////// MANDATORY ////////////////////////////////// MANDATORY //

SERVICE BULLETIN

DATE: August 3, 2000

PAGE 5 of 5

// MANDATORY ////////////////////////////////// MANDATORY ////////////////////////////////// MANDATORY //

Compliance Recording Form

Original T/R Gearbox attach hardware: Bolts _____

Final T/R Gearbox attach hardware: Bolts _____ Washers _____

Shim between gearbox and tailboom: none _____ .031 _____ .062 _____

Method of Inspection (I or II): _____

Customer/Operator Name: _____

Address: _____

Phone: _____

Fax: _____

Aircraft Serial No.: _____

Tailboom P/N: _____ S/N: _____

Helicopter Total Time: _____

Date of Compliance: _____

Signature of Person Confirming Compliance: _____

To obtain your revised copy of YH-237, fax this form to: Aerometals Engineering Department, 916-939-6555. Or mail to Aerometals, 3920 Sandstone Drive, El Dorado Hills, CA 95762 USA

// MANDATORY ////////////////////////////////// MANDATORY ////////////////////////////////// MANDATORY //